

Include and Assemble the Aeon Labs Door / Window Sensor

This manual will help you to include and assemble the Aeon Labs Door / Window Sensor. After you have walked through this guide you will be able to use the door sensor in a variety of scenes, scenarios and alarm settings.

1. Logging in to your e-Centre



- Start your computer or notebook.
- Open a browser, for example Chrome or Firefox.
- Open the e-Centre webpage via <http://ecentre>. Or go to the IP address of the e-Centre, for example <http://192.168.1.100>.
- Log in with the standard PIN code 1234, or use your own PIN code.

2. Add the Aeon Labs Door Sensor to your e-Centre

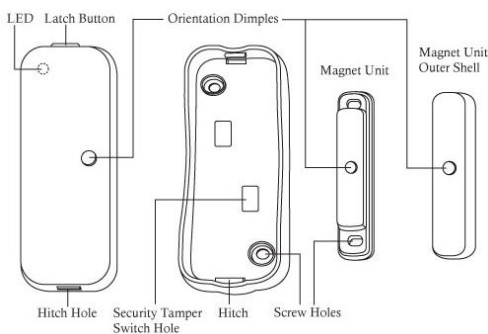

If your home is fitted with several e-Domotica accessories (mains powered Z-wave devices): it is recommended to include the door sensor at the place where you will assemble it. Notice that you check the box named 'Normal/High power'. Also this only works when you already use a Z-Wave network.

At first we will include the Door Sensor to your e-Centre. Please follow the steps below to proceed:

- Remove the plastic between the batteries and the door sensor. You can open the door sensor by pressing the Latch Button. In the picture on the left you can find where the Latch Button is placed. When finished, don't close the door sensor
- On the webpage go to 'e-Domotica Products'
- At the right down corner click 'Include'
- Press the Z-Wave button once. You can find the button next to the batteries
- Wait patiently while the e-Centre will include the door sensor. When finished name the sensor, choose a location and assign an icon. Next click 'Save'.

3. Assemble the door sensor

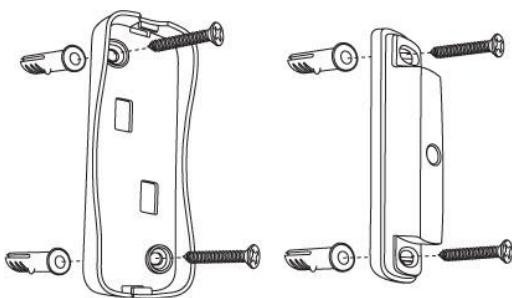

Now that the door sensor is connected to the e-Centre, we can assemble it. There are two possibilities to mount. You can screw or stick it. Although screwing is recommended more, both possibilities are agreeable. If you decide to screw it, the door sensor will be less delicate to be sabotaged.

In the picture on the left you will see how to assemble the door sensor in both ways.

Please notice that the Orientation Dimples must be pointed to each other (see picture below). Also it's recommended to keep both the door sensor and the magnet within a 2cm range.

OR

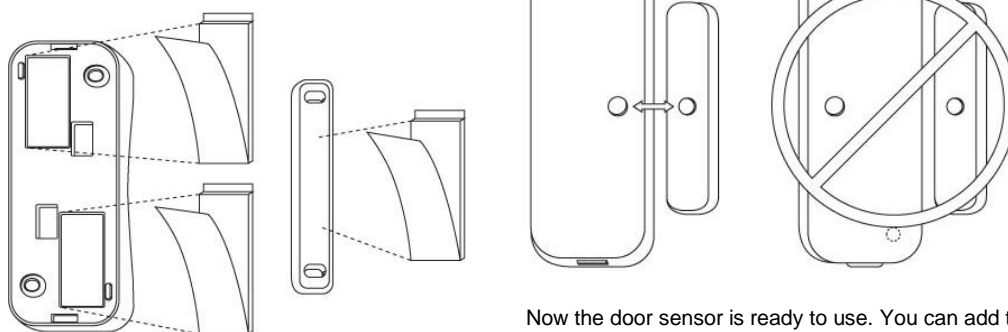

Now the door sensor is ready to use. You can add the door sensor to a variety of scenes, scenarios and alarm settings.

Visit our website for more manuals, instructions, examples and installation videos.